

# Eastoke Corner adiZone

Elaine Clarke  
Cultural Services Team Leader  
Havant Borough Council  
Tel: 023 9244 6421  
[elaine.clarke@havant.gov.uk](mailto:elaine.clarke@havant.gov.uk)

# What is an adiZone?

- An adiZone is a 25m<sup>2</sup> multi-sports facility designed in the shape of the London 2012 Olympic logo to create a sporting legacy
- The facility includes a large outdoor gym, basketball and football area, climbing wall, tennis wall and a freestyle area for aerobics, dance and martial arts etc.
- It is fully inclusive with accessible ramps and equipment designed to be suitable for people with visual impairments or learning disabilities
- the adiZone has been designed and sponsored by adidas working with the Department for Children Schools and Families and the Great Outdoor Gym Company





# Funds

Havant Borough Council has raised funds for this project from a number of internal and external sources, these include:

- Development contributions
- Hampshire County Council - Aiming High grant
- Department of Children Schools and Families (DCSF) / adidas sponsorship
- Central government award for meeting local targets

# Aiming High Consultation

## Funding Criteria:

- consultation with children and young people with disabilities to determine their requirements
- a destination site where children and parents would want to travel to and stay for a length of time
- disabled parking and toilets nearby

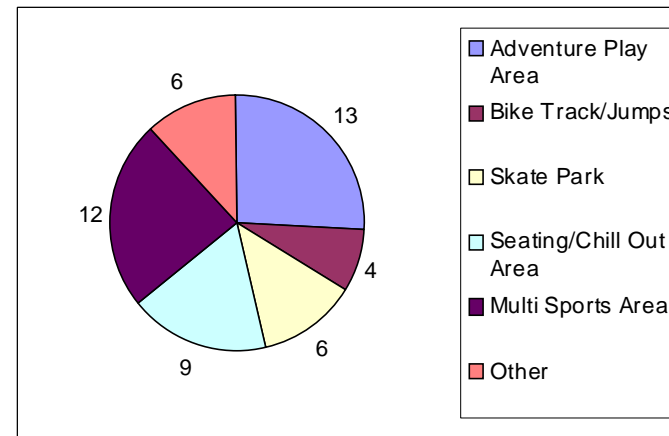
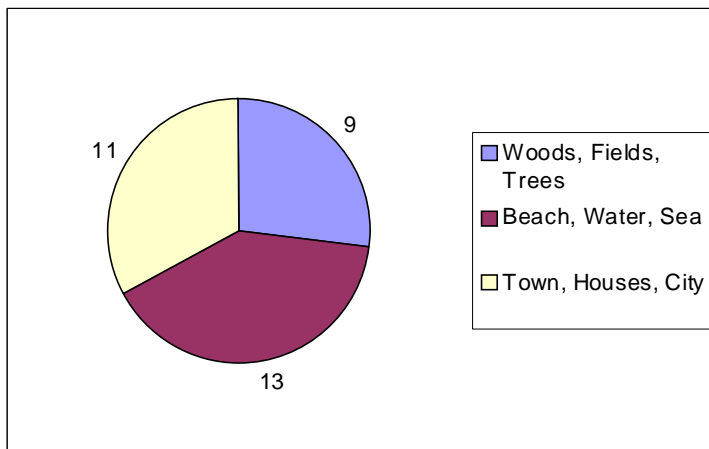
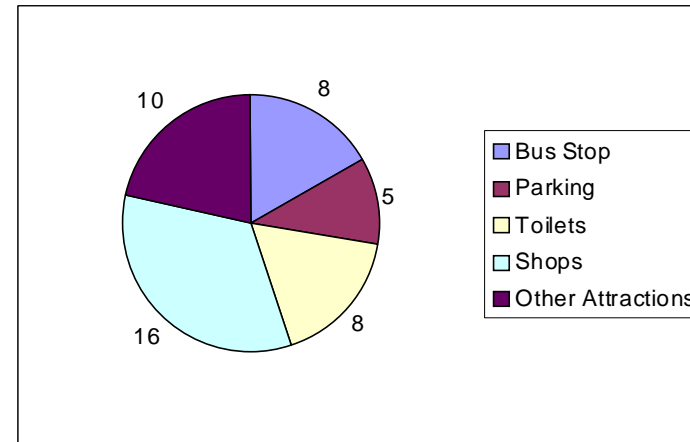

# DCSF / adidas sponsorship bid

- Hayling Island Master plan
- Liveability project to develop Eastoke Plaza
- Olympic legacy
- Health and well-being
- Anti-social behaviour
- Support from Hayling College, Hayling Island Community Board, Hayling Island Community Centre, Haylings B.E.S.T., Councillor Lenaghan Sergeant Pratley and Mr Haddock, miniature railway operator

# Site Plan

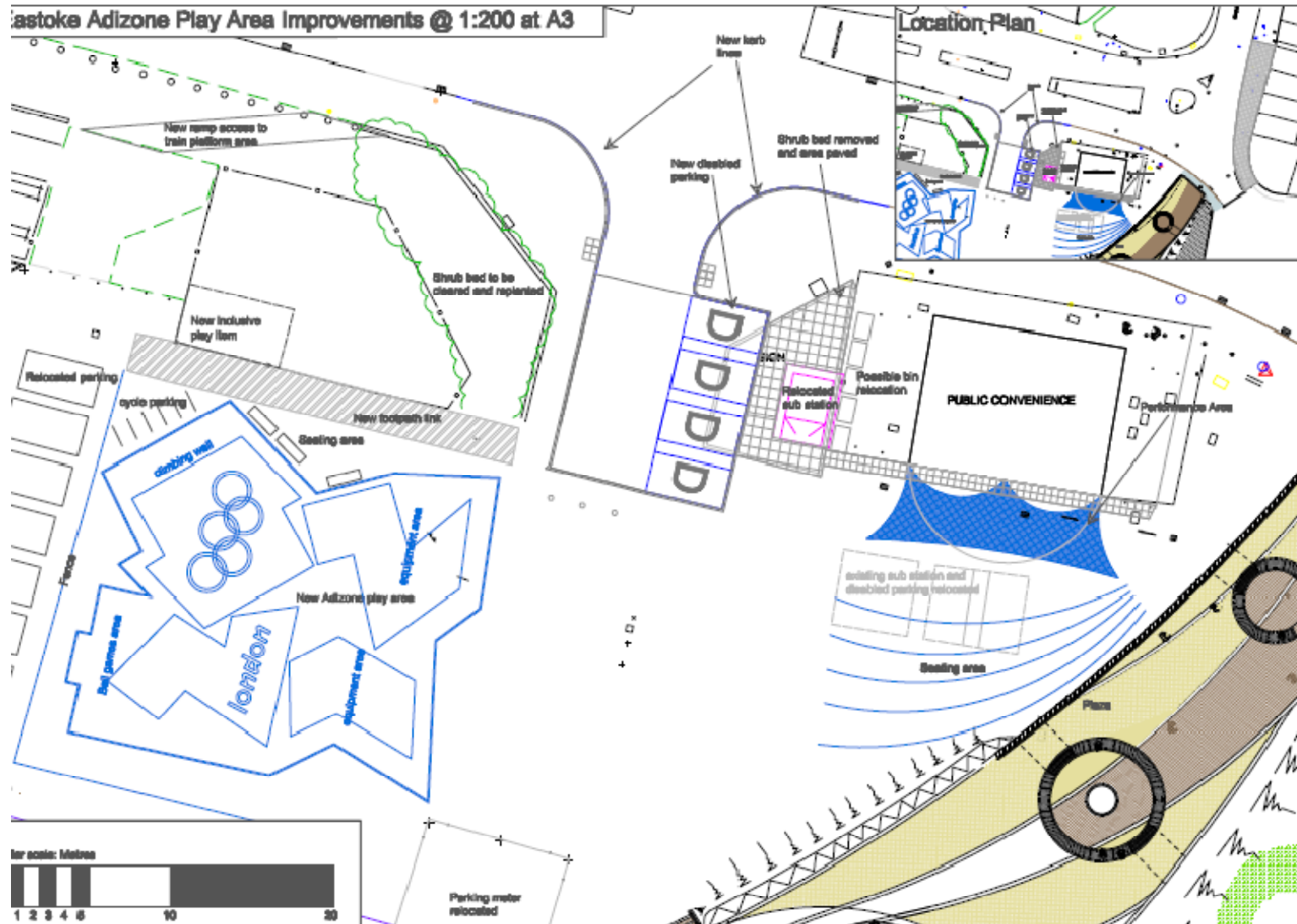

# Site considerations

- check size and levels
- coastal wall
- loss of up to 15 parking spaces
- impact on traders
- new entrance to car park
- turning bay for vehicles
- additional disabled parking
- fencing
- play area improvements
- disabled access

# Community Engagement Plan

1. School activities
2. Sports Club activities
3. Family activities
4. Adults (16+ ) activities
5. Children & Young People activities
6. Inclusive activities
7. Marketing & Promotion

# Next steps

- Havant Borough Cabinet approval 'subject to Community Board endorsement' (Jan)
- Site survey (Jan/Feb)
- Planning application (Feb-Apr)
- Contractual agreement, subject to planning approval (May)
- Press announcement – national campaign (May/June)
- Works on site (May-July)
- Launch event (August)